

# 2<sup>nd</sup> Project Committee Meeting

*Rethymno, Crete, Greece*  
*July 2 – 4, 2014*



© 2014 PEARL

This project has received funding from the European Union's Seventh Framework Programme for Research, Technological Development and Demonstration under Grant Agreement No 603663 for the research project PEARL (Preparing for Extreme And Rare events in coastal regions). All rights reserved. No part of this book may be reproduced, stored in a database or retrieval system, or published, in any form or in any way, electronically, mechanically, by print, photoprint, microfilm or any other means without prior written permission from the publisher.

The deliverable reflects only the author's views and the European Union is not liable for any use that may be made of the information contained



## 1. The Venue: Aegean Pearl

The 2<sup>nd</sup> PEARL Project Committee Meeting will be hosted in the Aegean **PEARL** Hotel (Figure 1).

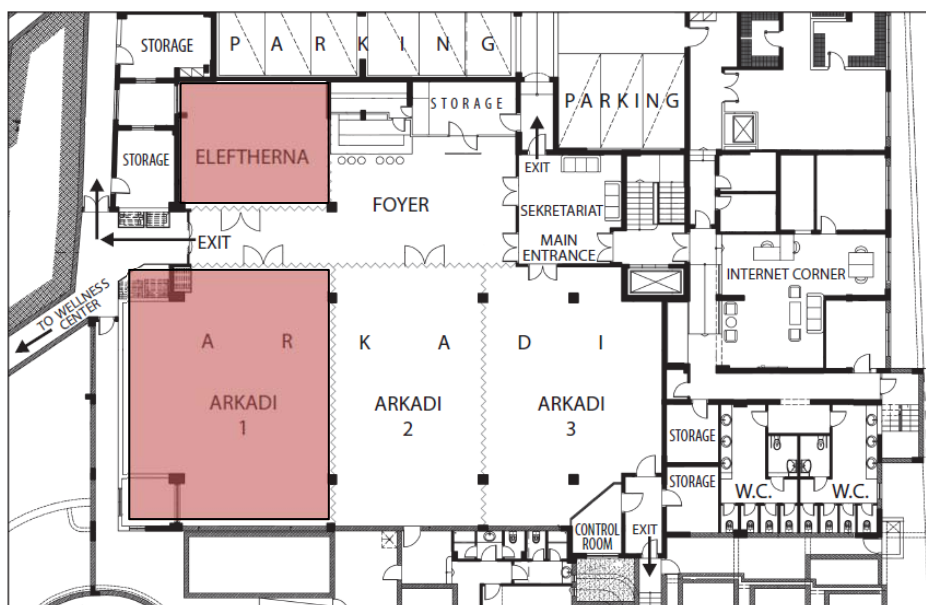

Figure 1: Aegean Pearl Hotel and its Conference Rooms

Aegean Pearl is situated along the beach at the end of the Rethymno beach promenade, overlooking the Mediterranean and within walking distance (2,2 Km or 1,3 miles) from the heart of the Old Town of Rethymno (Figure 2).

The hotel address is: Afstralon Polemiston Str.28 GR-74100 Rethymno - Crete – Greece

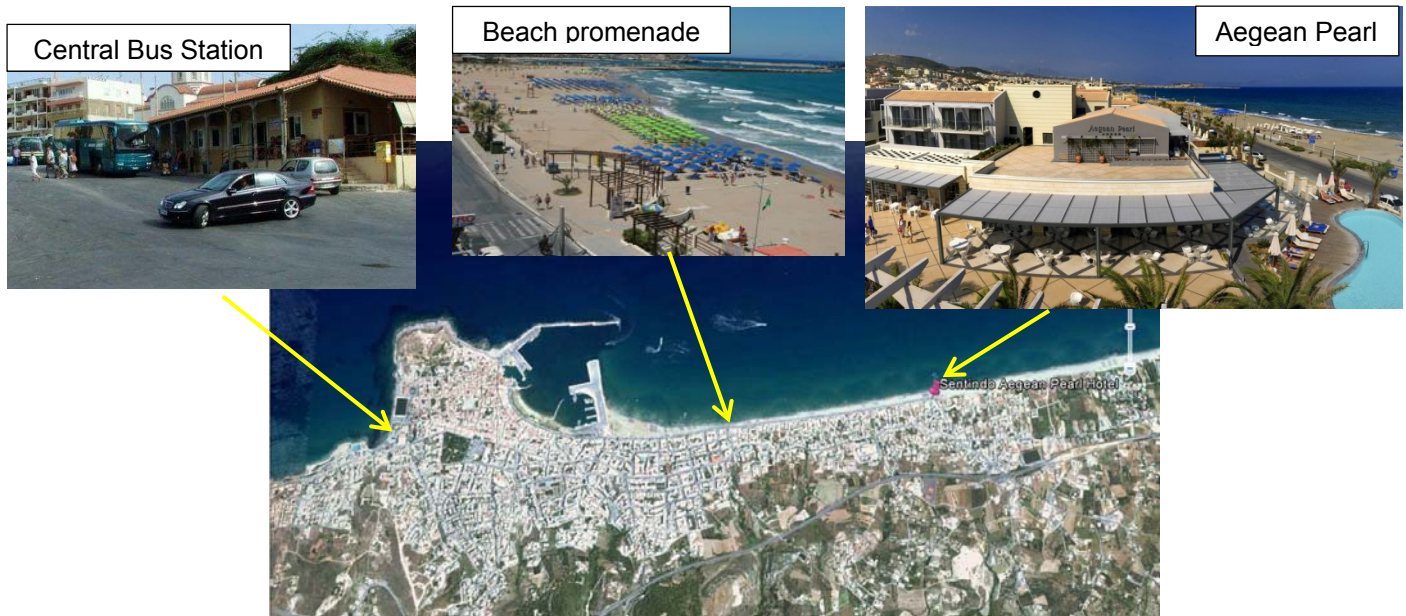

Figure 2: Location of Aegean Pearl Hotel

## 2. Airports

The nearest airports are (Figure 3):

- Chania Airport Ioannis Daskalogiannis (CHQ) – 65 Km (40 miles) from Aegean Pearl
- Heraklion Airport Nikos Kazantzakis (HER) - 72 Km (45 miles) from Aegean Pearl

Travelling to Heraklion Airport is slightly more convenient due to the frequent flights available and the connection of the airport with the central bus station.

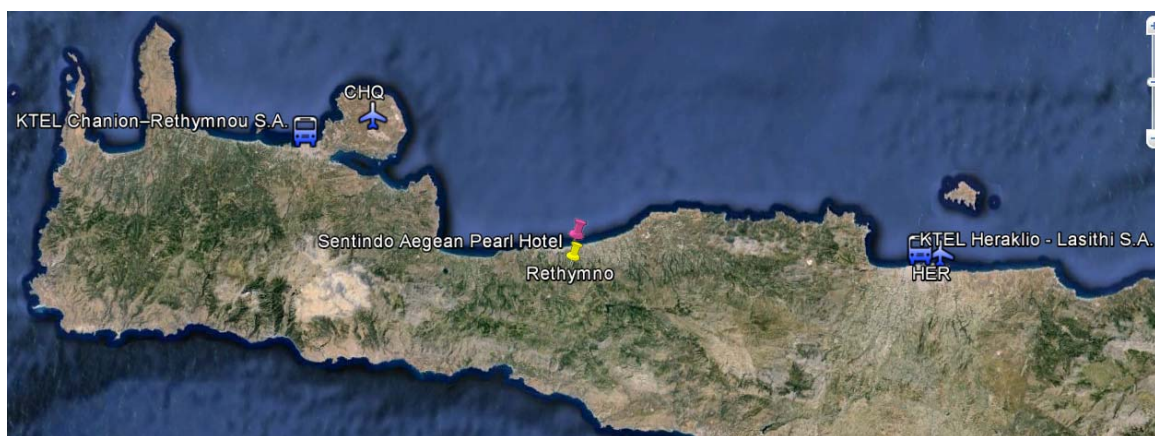

Figure 3: Nearest airports and central bus stations

### 3. Connection from Heraklion International Airport (HER) to Aegean Pearl:

HER → KTEL Heraklio - Lasithi S.A., Heraklio → Perivolia bus stop, Rethymno → Pearl

**Bus \*:**

Travel time: 10-20 min  
Ticket: 1 - 2 euros

**Taxi:**

Travel time: 7 - 10 min  
Cost: 8 -10 euros

**Bus\*\*:**

Travel time: 1 hr and 20 min  
Ticket: 7 - 8 euros

**On foot:**

Travel time: 5 min

**Taxi:**

Travel time: about 1 hr  
Cost: 90 - 100 euros

Local buses (\*) leave from the airport every 10 minutes (all the bus numbers apart from bus number 5) which will transport you near to the central bus station (KTEL Heraklio - Lasithi S.A.) in order to get the intercity bus (\*\*) for Rethymno. The local bus leaves you 300 m away from KTEL Heraklio - Lasithi S.A. (see

Figure 4). Timetables for the intercity bus are available on the website:

<http://www.ktelherlas.gr/index.php> : Departures from the station at the port to Rethymno, Chania

Alternatively, you can get a taxi from the airport to the central bus station (KTEL Heraklio - Lasithi S.A.) which will cost you approximately 10 euros and will take 10 min.

Getting a taxi from the airport directly to Rethymno will cost approximately 90 euros and will take 1 hr.

To reach the hotel by bus, stop at the Perivolia bus stop, at the junction of Oplarchigou Pachla Street and Afstralon Polemiston Street (Figure 5). The Aegean Pearl Hotel is situated 350 meters from Pervolia bus stop (Figure 5).

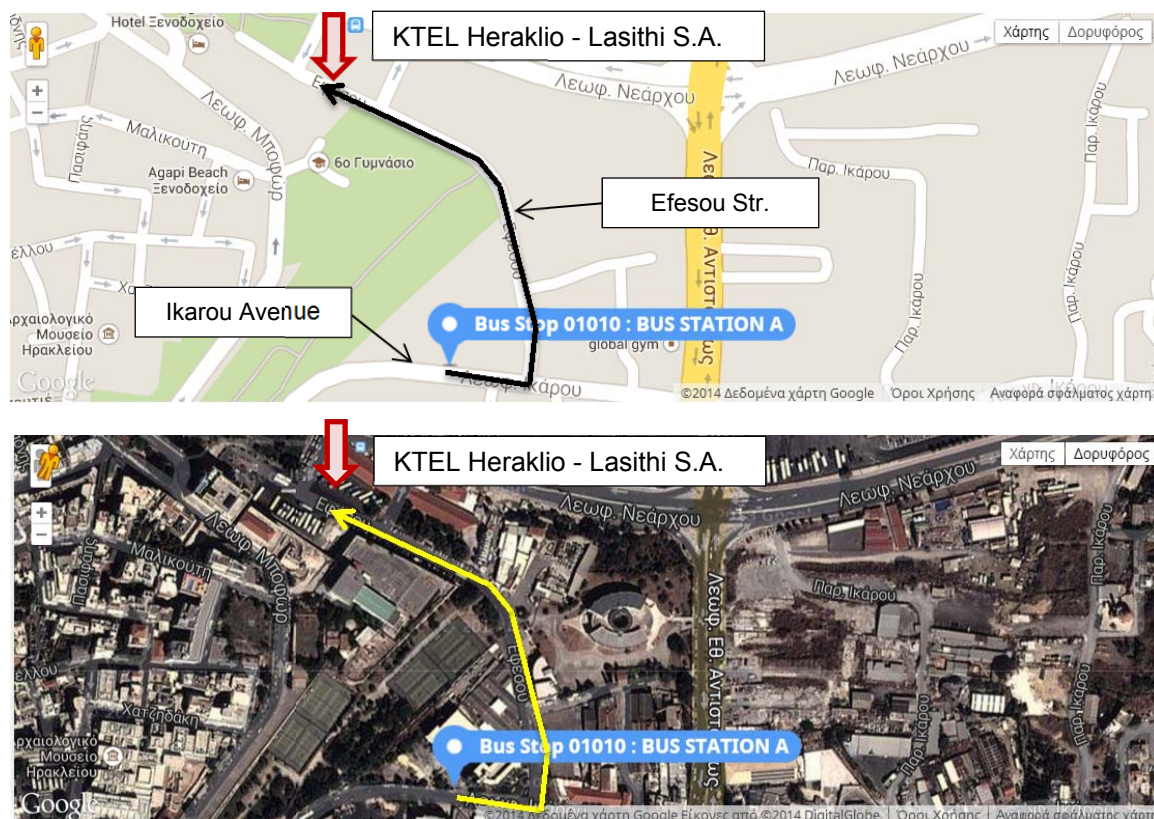

Figure 4: Bus stop in Heraklio, route to KTEL Heraklio - Lasithi S.A.

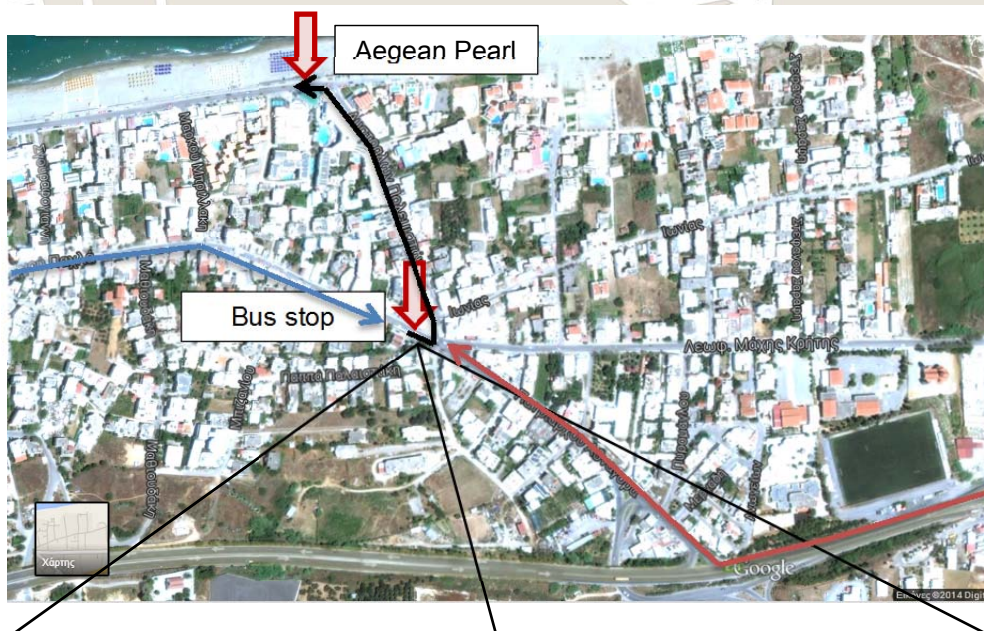
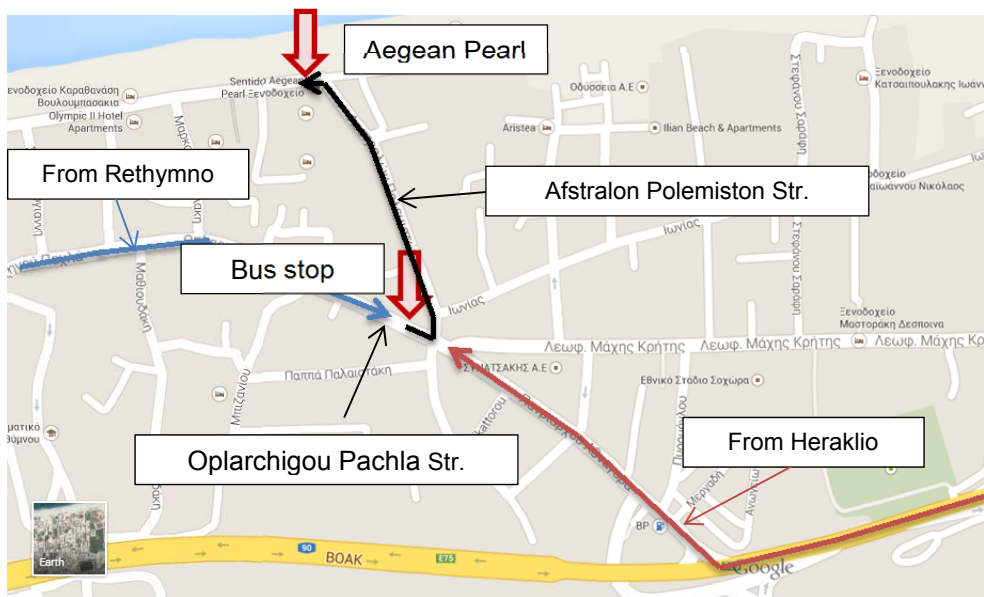

Figure 5: Bus stop in Rethymno, route to Aegean Pearl

#### 4. Connection from Chania International Airport (CHQ) to Aegean Pearl:

CHQ → KTEL Chanion–Rethymnou S.A., Chania → KTEL Chanion-Rethymnou, Rethymno → Pearl

**Bus \*:**  
Travel time: 30 min  
Ticket: 2 - 3 euros  
**Taxi:**  
Travel time: 15 – 20 min  
Cost: 20 euros

**Bus\*\*:**  
Travel time: 1 hr  
Ticket: 6 - 7 euros

**Bus\*\*\*:**  
Travel time: 10-15 min  
Ticket: 1 - 2 euros  
+  
**On foot:**  
Travel time: 5 min  
**Or**  
**Taxi:**  
Travel time: 7 – 10 min  
Cost: 5 – 6 euros

**Taxi:**  
Travel time: 50 min - 1 hr  
Cost: 80 - 90 euros

Local buses (\*) leave from the airport at specific departure times which will transport you to the central bus station KTEL Chanion–Rethymnou S.A. in Chania in order to get the intercity bus (\*\*) for Rethymno. The intercity bus will transport you to the central bus station in Rethymno where you will have to take the local bus to approach the Pearl Hotel. The local bus leaves you at 350 m away from Pearl at Pervolia bus stop (Figure 5) where you will have to walk approximately 5 min in order to arrive at Pearl. Due to the short distances and the low cost perhaps it would be more convenient to take a taxi from the central bus station in Rethymno to Pearl Hotel. It will cost you approximately 6 euros and will take just 7 – 10 min. Direct transportation from Chania airport to Rethymno (Pearl) by taxi will cost approximately 90 euros and it will take 1hr.

Timetables, ticket prices and travel time for every route are available at the official web site of the KTEL Chanion-Rethymnou (West Crete Bus Service): <http://bus-service-crete-ktel.com/default.html>

\*: Supraregional line to Chania Airport with departure from Hania

\*\*: Supraregional MAIN LINE Hania - Rethymnon – Heraklion

\*\*\*: Suburban service around Rethymnon, to the HOTEL AREA (Rethymnon - Skaletta - Creta Panorama) and to Panormo.

Taxis ranks are located just outside the above mentioned stations (CHQ, KTEL Chanion-Rethymnou).

#### 5. From Aegean Pearl to Center of the town and back:

Rethymno is a small city where you will not have to travel a considerable distance to whichever destination you wish. Following the road in Figure 5, you can get to the nearest bus stop. Local buses will transport you to the center of Rethymno. Taxis are also located just outside the hotel. Getting to the center of the town is only a 5 minute taxi ride away (and will cost less than 5 euro). In addition, you always have the choice to walk a 2 Km distance next to the sea from the Aegean Pearl Hotel to the Old Town of Rethymno.

#### 6. Possible Hotels to book:

- a. Pearl Beach Hotel - <http://www.pearlhotels.gr/>

- b. Atlantis Beach Hotel - <http://www.atlantisbeach.gr/>
- c. Bio Suites Hotel - <http://www.biohotel.gr/>
- d. Grecotel Creta Palace - <http://www.cretapalace.com/>
- e. Aquila Port Rethymno - [http://www.aquilahotels.com/new/en/index.php?p=3\\_12](http://www.aquilahotels.com/new/en/index.php?p=3_12)
- f. Theartemis Palace Hotel - <http://www.theartemis.gr/index.php>

Rethymno is a tourist destination, therefore, there are plenty more hotels, apartments or suites where you can book at any price, place, hotel type or star rating.

In case you have any further questions please do not hesitate to contact us.

Contact Person: Dia Lykou (NTUA), [alykou@central.ntua.gr](mailto:alykou@central.ntua.gr)