



Natasa Manojlovic, TUHH, Germany

Extreme Weather Preparedness

Brought to you by  **SustainableCitiesCollective**

Schneider
Electric

Towards Resilient Risk Governance

Holistic View of Risk

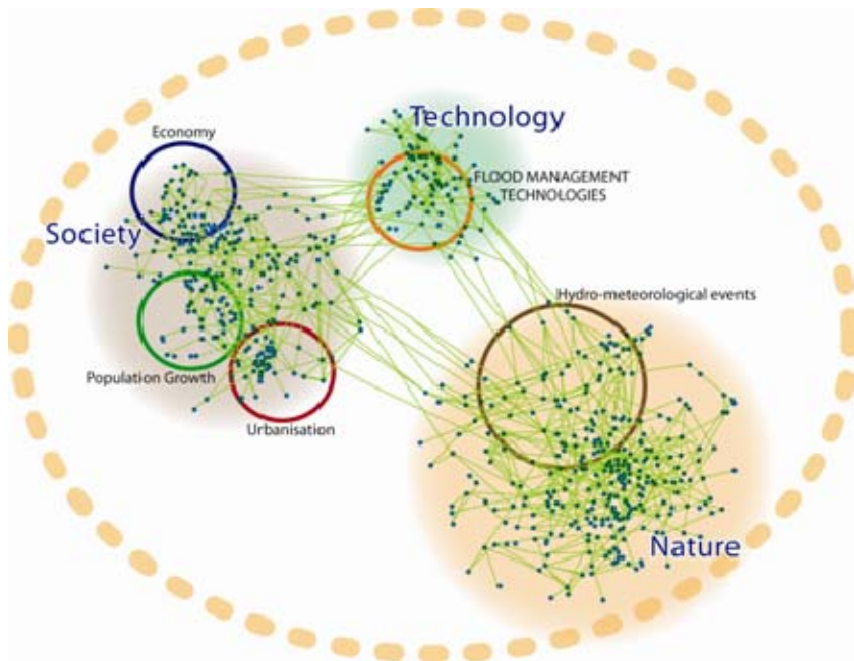

Root causes of risk

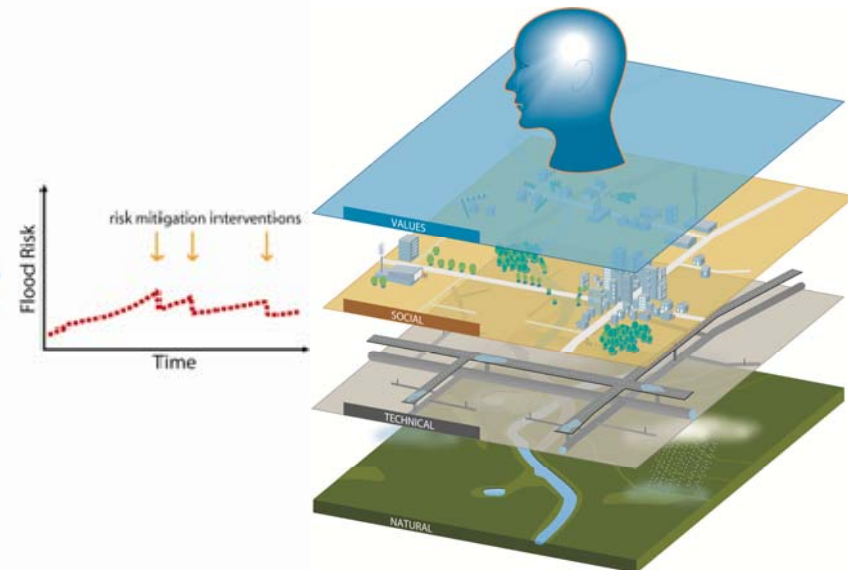

- *Interrelatedness and Interactions*
- *Multiple hazards and risk (e.g. cascading)*

(Source: Vojinovic&Abbott 2012)

FP7 EU Project PEARL- Preparing for Extreme and Rare Events in Coastal Regions
(<http://www.pearl-fp7.eu/>)

Appropriate Flood Resilient Technology & Systems

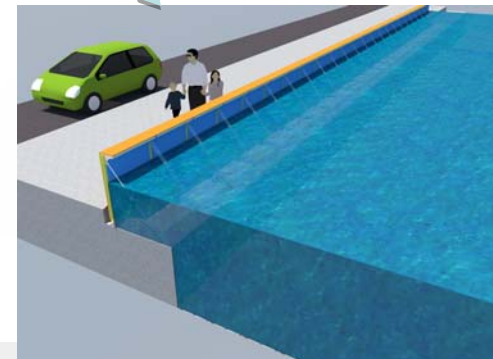
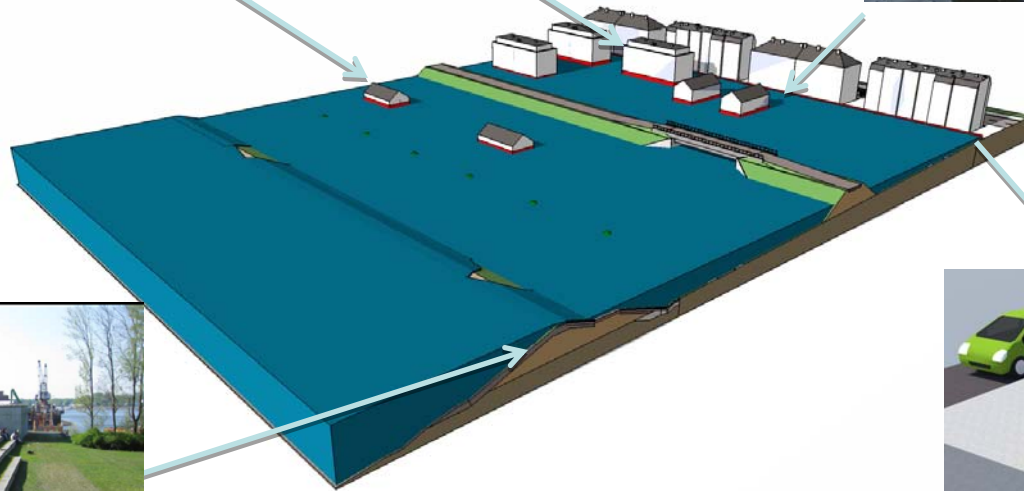

- „System thinking“
- Innovation
- Adaptation to local building and lifestyle

Source: Toumazis 2012

Empowering Stakeholders

Bottom up strategy for risk governance (Learning and Action Alliances):



Adapted from Ashley et al., 2009)



Key issues:

- Trust
- Visibility&Branding
- Mutual learning
- Innovation
- Novelty
- Motivation
- Legitimacy
- Legacy

Thank You for Joining Us

- This webinar will be available on-demand at www.SustainableCitiesCollective.com.

Stop by to learn more, download a recording of the webinar, and share your comments.

